



ST IVES TOWN COUNCIL

Town Hall, Market Hill, St Ives,
Huntingdonshire PE27 5AL
Tel: 01480 388929
e-mail: clerk@stivestowncouncil.gov.uk

TWINNED WITH STADTALLENDORF

Issued: 22 February 2024

Cllrs R Chapman, C Morgan, A Thompson, J Tiddy, N Wells, J Kerr, M Gleadow

You are hereby summoned to attend a Meeting of the **Planning Committee** of St Ives Town Council to be held in the **Town Hall** on **Wednesday 28 February at 7.00 pm**.

Libby White

Mrs Libby White BEM BA(Hons) FSLCC
Locum Clerk

AGENDA

Presentation: to receive a short presentation on the proposals for the Broadway Scheme

PL95.00 APOLOGIES FOR ABSENCE

To receive and accept apologies for absence.

PL96.00 DECLARATIONS OF INTEREST

To receive Declarations of Disclosable and/or Non-disclosable Pecuniary Interests as set out in Chapter 7 of the Localism Act 2011 and the nature of those interests relating to any Agenda item.

PL97.00 PUBLIC PARTICIPATION

A maximum of 15 minutes in total is permitted for members of the public to address the Committee in accordance with the Town Council's approved Public Participation Policy. Each participant will be limited to 3 minutes in which to make their comments. Comments will be summarised in the minutes.

PL98.00 MINUTES

To confirm as a correct record the Minutes of the Planning Committee held on 14 February 2024 (copy herewith).

PL99.00 PLANNING APPLICATIONS

To consider the attached list of Planning Applications received (copy herewith).



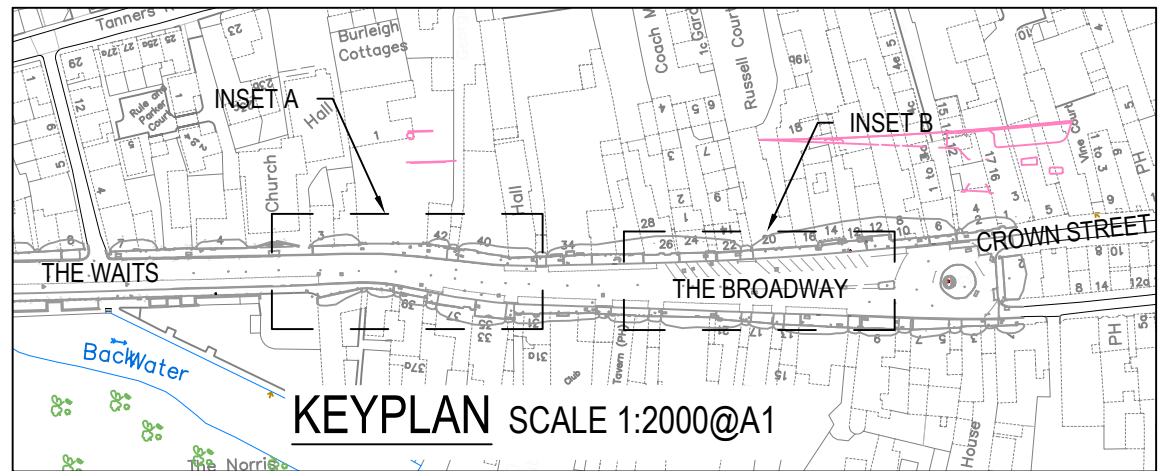
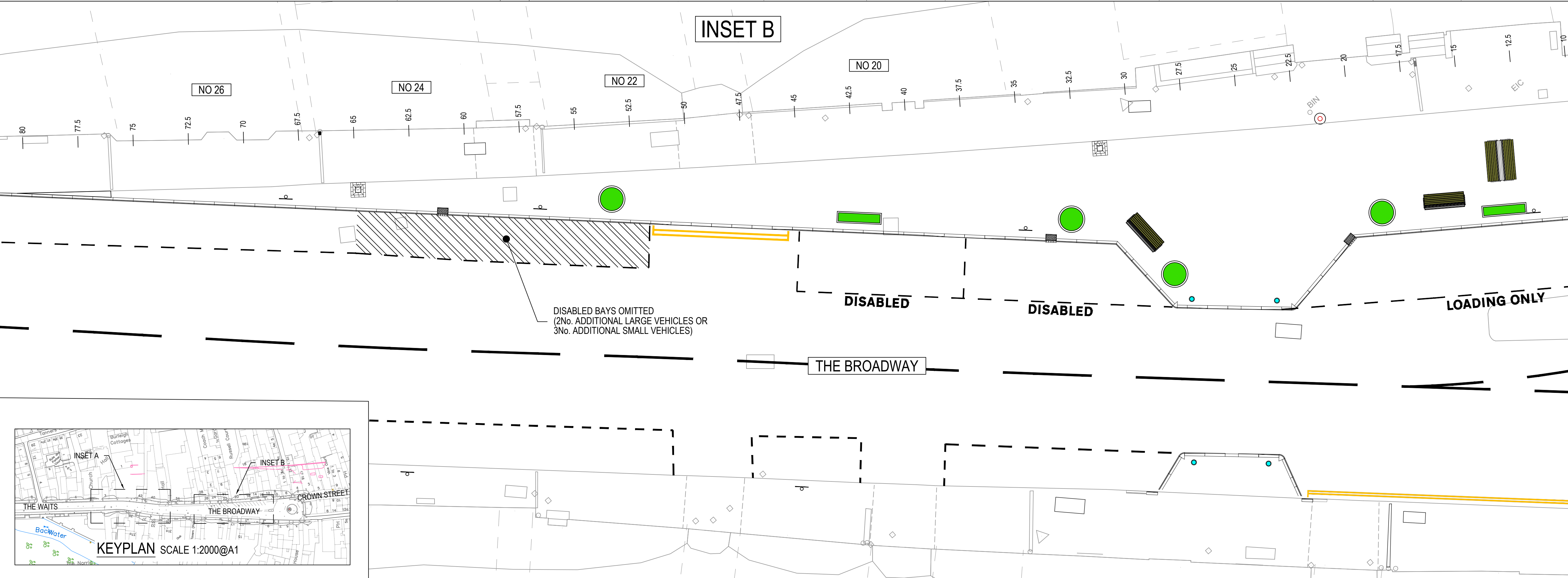
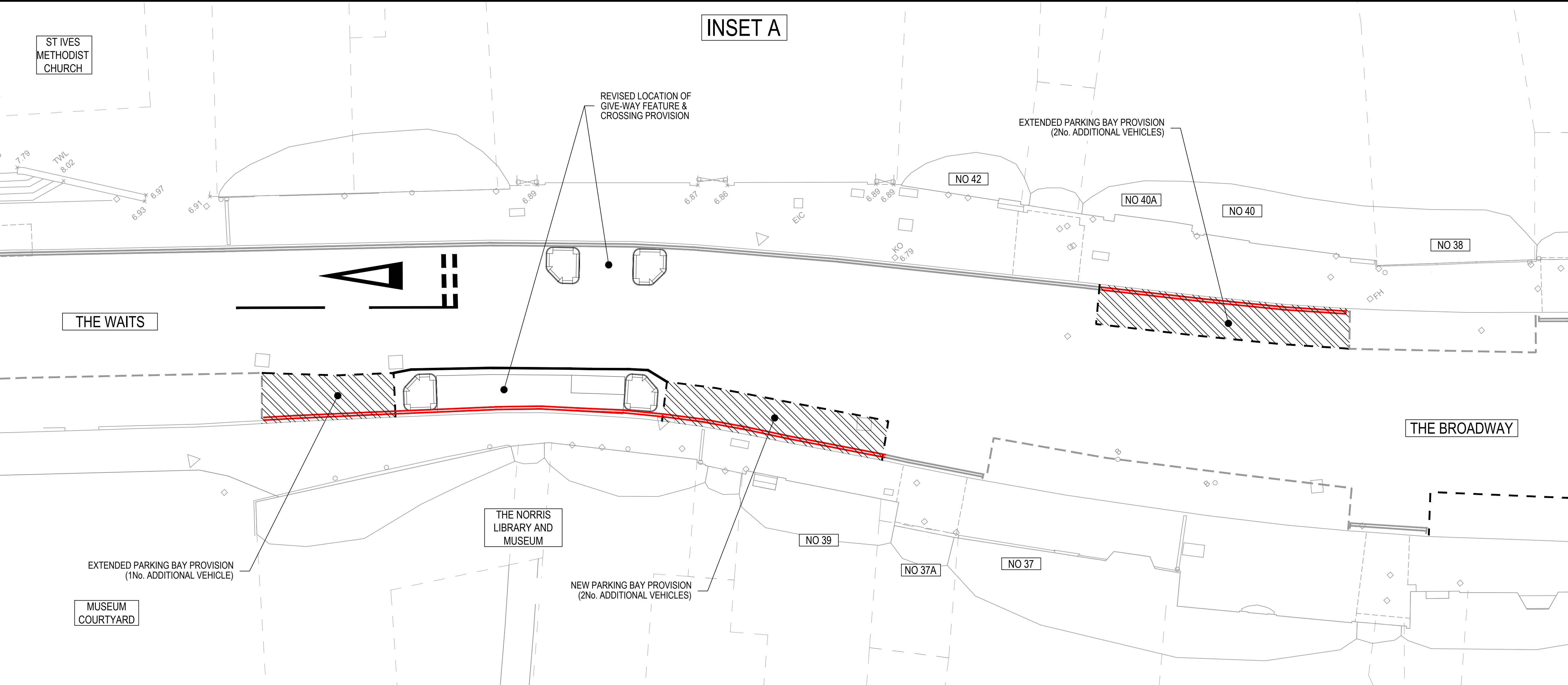

Date	Rev	Description
20/02/24		DRAFT, FOR INFORMATION



Project
**THE BROADWAY, ST IVES
STREETSCAPE
IMPROVEMENTS 23/24**

Title
**THE WAITS CROSSING &
ADDITIONAL PARKING BAYS
SKETCH**

Scale	Drawn	Checked	Date
1:100@A1	MHS		20/02/2024

Based upon Ordnance Survey material with the permission of the controller of Her Majesty's Stationery Office. Unauthorised reproduction infringes copyright and may lead to prosecution. © Crown Copyright and database rights (2020) Ordnance Survey **100023205**

Drawing number	Rev
30CPX04287/D/XXXX	

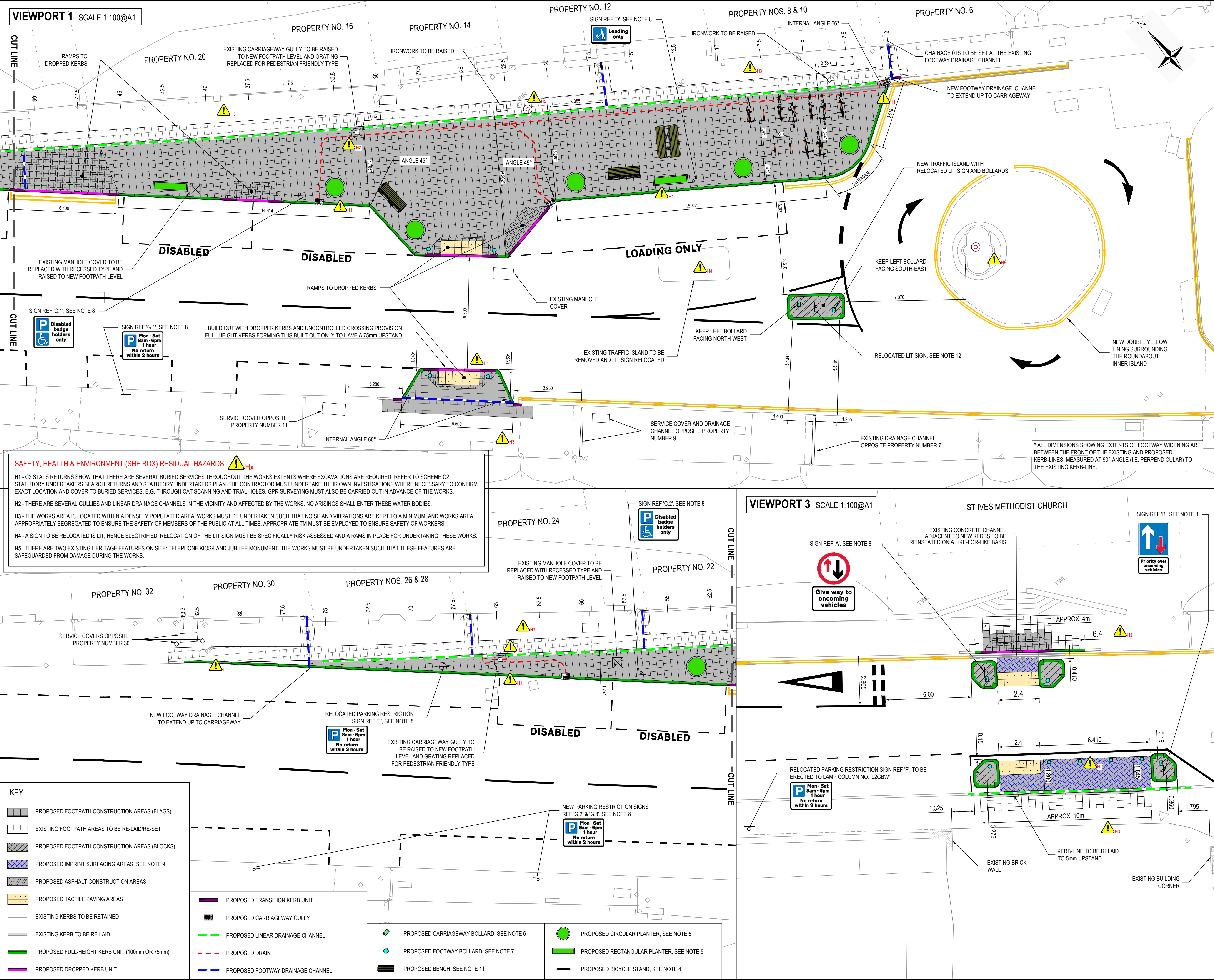

VIEWPORT 1 SCALE 1:100@A1

VIEWPORT 3 SCALE 1:100@A1

ST IVES METHODIST CHURCH

RELOCATED PARKING RESTRICTION SIGN REF 'F', TO BE ERECTED TO LAMP COLUMN NO. 12GBW

KEY

PROPOSED FOOTPATH CONSTRUCTION AREAS (FLAGS)

EXISTING FOOTPATH AREAS TO BE RE-LAID/RE-SET

PROPOSED FOOTPATH CONSTRUCTION AREAS (BLOCKS)

PROPOSED IMPRINT SURFACING AREAS, SEE NOTE 9

PROPOSED ASPHALT CONSTRUCTION AREAS

PROPOSED TACTILE PAVING AREAS

EXISTING KERBS TO BE RETAINED

EXISTING KERB TO BE RE-LAID

PROPOSED FULL-HEIGHT KERB UNIT (100mm OR 75mm)

PROPOSED DROPPED KERB UNIT

PROPOSED TRANSITION KERB UNIT

PROPOSED CARRIAGEWAY GULLY

PROPOSED LINEAR DRAINAGE CHANNEL

PROPOSED CARRIAGEWAY BOLLARD, SEE NOTE 6

PROPOSED FOOTWAY BOLLARD, SEE NOTE 7

PROPOSED BENCH, SEE NOTE 11

PROPOSED CIRCULAR PLANTER, SEE NOTE 5

PROPOSED RECTANGULAR PLANTER, SEE NOTE 5

PROPOSED BICYCLE STAND, SEE NOTE 4

DRG_101 NOTES

1. ALL DIMENSIONS GIVEN IN THIS DRAWING ARE IN MILLIMETRES UNLESS SPECIFICALLY STATED OTHERWISE.

2. THIS DRAWING IS TO BE READ IN CONJUNCTION WITH ALL RELEVANT DOCUMENTATION NO. 30CPX04287/D/... INCLUDING, BUT NOT LIMITED TO THE SCHEME'S PRE-CONSTRUCTION INFORMATION.

3. THE EXACT SITING AND POSITIONING OF STREET FURNITURE MUST BE AGREED ON SITE WITH CCC REPRESENTATIVE. ALL STREET FURNITURE, INCLUDING PLANTERS, BENCHES, FOOTWAY AND HIGHWAY BOLLARDS TO BE INSTALLED IN ACCORDANCE WITH THE MANUFACTURER REQUIREMENTS/RECOMMENDATIONS.

4. BICYCLE STANDS TO BE CONSERVATION TYPE, SURFACE MOUNTED INDIVIDUALLY TO ENSURE EASE OF FUTURE REMOVAL. BICYCLE STANDS TO BE 'CYCLE-WORKS CONSERVATION STAND' OR SIMILAR APPROVED, SURFACE MOUNTED TO APPROPRIATELY INSTALLED M10 BOLT ANCHOR SOCKETS.

5. TWO TYPES OF PLANTERS ARE PROPOSED: A CIRCULAR TYPE, AND A RECTANGULAR TYPE. THE CIRCULAR TYPE SHALL HAVE AN OUTER DIAMETER BETWEEN 1m AND 1.2m. THE RECTANGULAR TYPE SHALL HAVE LENGTH AND WIDTH OF BETWEEN 1.8m TO 2.2m AND 0.4m TO 0.7m RESPECTIVELY. ALL PLANTERS SHALL BE SURFACE MOUNTED, REMOVABLE, AND LIFTABLE WITH A FORK-LIFT. ALL PLANTERS MUST HAVE A DARK GREY COLOUR. PLANTERS TO BE 'MARSHALLS BOULEVARD 1200 CIRCULAR PLANTER' AND 'MARSHALLS BOX PLANTER' OR SIMILAR APPROVED. ALL PLANTERS SHALL HAVE AN OFFSET OF 0.45m FROM THE ADJACENT CARRIAGEWAY.

6. NEW 'KEEP LEFT' OR 'KEEP RIGHT' BOLLARDS TO BE REMOVABLE AND HIGHWAY SPECIFICATION 'GLASDON SIGMASTER ULTRA 50' OR SIMILAR APPROVED, INSTALLED WITH COMPATIBLE RETENTION SOCKET.

7. NEW FOOTWAY BOLLARDS TO BE PASSIVELY SAFE TO BS EN 12767, CONSERVATION TYPE. ALL BOLLARDS MUST HAVE WHITE REFLECTIVE BANDS AND MUST BE REMOVABLE. NEW FOOTWAY BOLLARDS TO BE 'GLASDON MANCHESTER BOLLARD IMPACTAPOL REBOUND, LOCKFAST DURAPOL SOCKET WITH ADDITIONAL SECURITY' OR SIMILAR APPROVED.

8. FOR THE CONSTRUCTION DETAILS OF THE NEW PROPOSED PRIORITY SIGNAGE, REFER TO SEPARATE DOCUMENT PROVIDED AS PART OF WORKS INFORMATION WITH THE RELEVANT REFERENCE NUMBER.

9. THE IMPRINT SURFACING SHALL BE RESIN BASED, HARD WEARING TYPE, GREYLIGHT GREY COLOUR WITH HERRINGBONE PATTERN. THE IMPRINT SURFACING SHALL BE FINISHED FLUSH WITH THE ADJACENT CARRIAGEWAY. IMPRINT SURFACING TO BE 'HITEX TEXPRINT' OR SIMILAR APPROVED.

10. ALL PROPOSED TRAFFIC SIGNS AND ROAD MARKINGS ARE TO BE SUPPLIED AND INSTALLED IN ACCORDANCE WITH TSRGD 2016. DOUBLE YELLOW LINING SHALL BE 50mm THICKNESS, PRIMROSE YELLOW COLOUR.

11. PROPOSED BENCHES SHALL BE TRADITIONAL SEATING BENCH TYPE, APPROXIMATE DIMENSIONS 2000mm X 700mm. BENCHES TO BE 'GLASDON STANFORD SEAT & BENCH' OR SIMILAR APPROVED.

12. AN EXISTING LIT SIGN MUST BE RELOCATED TO THE NEW TRAFFIC ISLAND LOCATION. THE DESIGNS OF THE NEW LIT CONNECTION WILL BE PROVIDED SEPARATELY AND RELOCATION OF LIT SIGN WILL BE UNDERTAKEN BY BBLP.

Date

Rev

Description

24/11/23

20/12/23

A

DRAFT, FOR INFORMATION

DETAILED DESIGN, FOR PRICING

Cambridgeshire County Council

Project

THE BROADWAY, ST IVES STREETSCAPE IMPROVEMENTS 23/24

Title

GENERAL ARRANGEMENT

Scale

1:100@A1

Drawn

MHS

Checked

NF

Date

20/12/2023

Based upon Ordnance Survey material with the permission of the controller of Her Majesty's Stationery Office. Unauthorised reproduction infringes copyright and may lead to prosecution. © Crown Copyright and database rights (2020) Ordnance Survey 100023205

Drawing number

30CPX04287/D/0101

Rev

A

**Minutes of the Meeting of the Planning Committee of St Ives Town Council
held in the Town Hall on 14th February 2024**

Present:

Chair: M Gleadow

Councillors: J Kerr, C Morgan, A Thompson, J Tiddy

In attendance:

Locum Clerk: L White

2 Members of the public

PL90.00 APOLOGIES FOR ABSENCE

Apologies were received and accepted from Cllr Wells (work commitments) and Cllr Chapman (personal).

PL91.00 DECLARATIONS OF INTEREST

None.

PL92.00 PUBLIC PARTICIPATION

Civic Society have raised that there are a lack of trees on the Thicket Path – perhaps Muntjac overgrazing. Is it possible to plant some trees?

PL93.00 MINUTES

RESOLVED: the Minutes of the meeting held on 24th January 2024 were agreed as a correct record and signed by the Chairman.

PL94.00 PLANNING APPLICATIONS

PL94.01 24/00104/FUL Retention of covered structure for industrial use.

David Smith St Ives Ltd
Marley Road, St Ives

RESOLVED: Recommend no objection as the structure is behind a large earth mound and not visible. However, it would be prudent to consider how the company will deal with excess water from the roof i.e. rain water harvesting which could then be used for some business activities.

PL94.02 24/00173/TREE T1: Horse Chestnut to left of garden: thin crown by approx. 20%

Reason: to allow more light through canopy, the area is particularly dark as there are two other large trees close by

T2: Ash in centre of garden: reduce 5-6 longest branches by approx. 2m to lessen end weight on over-extended branches

Reason: a number of branches have recently snapped and fallen. End weight reduction should reduce the likelihood of future branch breakages on extended limbs

9 Wilson Way, St Ives

RESOLVED: Recommend support and pleased to see that there is sympathetic tree surgery and management.

The meeting concluded at: 19.10pm

Chair:

Dated: 28th February 2024

Chairman's
Initials

PLANNING APPLICATIONS
28 February 2024

Application No Applicant/Agent	Proposed Development	Link	Comments
24/00195/ADV Mr Oliver Brookes Cameron Bosque Brookes Architects 7 Hill Estate Houghton Huntingdon PE282BX	New fascia panel and screen Ground Floor 12 The Broadway St Ives PE27 5BN	https://publicaccess.huntingdonshire.gov.uk/online-applications/applicationDetails.do?activeTab=summary&keyVal=S86PXEIKKKT00	
24/00194/FUL Mr Oliver Brookes Cameron Bosque Brookes Architects 7 Hill Estate Houghton Huntingdon PE282BX	New external light and tiled steps, General repairs and refurbishment works Ground Floor 12 The Broadway St Ives PE27 5BN	https://publicaccess.huntingdonshire.gov.uk/online-applications/applicationDetails.do?activeTab=summary&keyVal=S86PXEIKKKS00	
24/00117/P3JPA Mr Martin Page Brown & Co The Fairways Wyboston Lakes Great North Road	Change of use from former GP surgery to 4 residential units with no external changes to the building The Old Exchange Surgery East Street St Ives	https://publicaccess.huntingdonshire.gov.uk/online-applications/applicationDetails.do?activeTab=summary&keyVal=S7RKMDIK0HJ00	

Wyboston Bedfordshire MK44 3AL	PE27 5PB		
24/00205/HHFUL Mr Andrew Cohu 85 Witherford Croft Solihull West Midlands B91 1UA	Replacement of old timber windows and timber/UPVC front and rear doors with new high efficiency UPVC windows and doors, plus changing UPVC/glass panel at front to brickwork to match existing. 66 Needingworth Road St Ives PE27 5JT	https://publicaccess.huntingdonshire.gov.uk/online-applications/applicationDetails.do?activeTab=summary&keyVal=S8DCPUIKKMD00	
24/00290/TREE Mr Chris Cole Eastern Tree Surgery Ltd 7 Heath Road Swaffham Prior Cambridge CB25 OLA	Lime – fell reason – previously pollarded at 6-7m high extensive decay at base of main stem risk of structural failure Broad Leas Court Broad Leas St Ives PE27 5XG	https://publicaccess.huntingdonshire.gov.uk/online-applications/applicationDetails.do?activeTab=summary&keyVal=S8UVC4IKKVP00	